



Yesterday • Today • Tomorrow



*36 Passenger
Without Luggage*

Cross Country



FEDERAL COACH

7400 South 28th Street • Fort Smith, AR 72908

Phone (479) 646-6800 • FAX (479) 646-1217

www.federalcoach.com • 800-292-6210

Every Federal Coach is custom handcrafted to meet the exact requirements of our valued clients. Features ranging from a co-pilot seat to decorative ceiling runners, front mounted TV/DVD players & unique overhead luggage systems are a few of the options that are available to you.

Things you need to know about Federal's Bus...

- ▶ **Weight Compliance** ▶ **Steel Cage**
- ▶ **Building in Passenger Safety with Durability & Quality**

Federal Coach takes singular pride in the objective to engineer and produce the highest quality, safest & most desired vehicles in the market today.

SAFETY IS FIRST WITH FEDERAL COACH!



FEDERAL COACH CROSS COUNTRY BUS SPECIFICATIONS

Dimensions

- | | | | | | |
|-------------------|-------|-------|--------------|-------------|---------|
| • Ceiling Height | 80.5" | 204cm | • GVWR | 22,000 lbs. | 9,979Kg |
| • Door Opening | 32" W | 81cm | • Length | 32.5' | 991cm |
| • Exterior Height | 126" | 320cm | • Passenger | Up to 36 | |
| • Exterior Width | 102" | 259cm | • Wheel Base | 233" | 592cm |

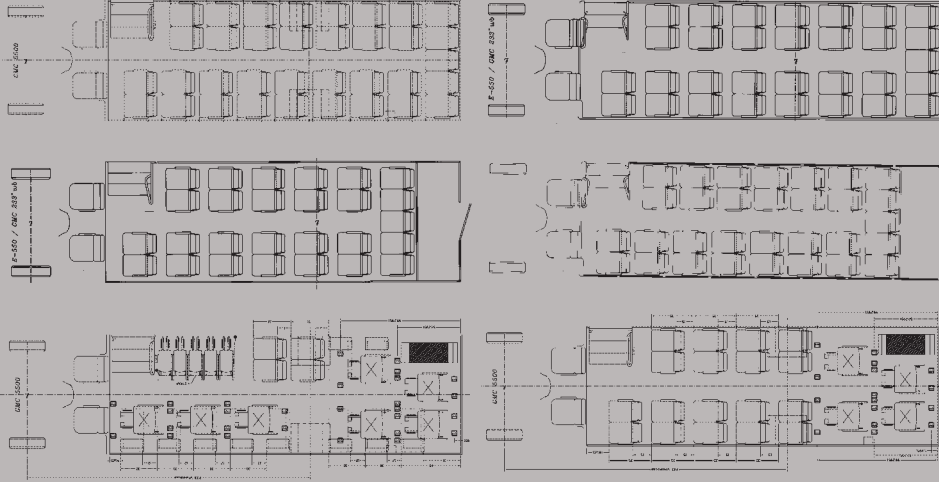

Additional Floor Plan Variations Available (See Your Local Dealer)

Standard Chassis Features Super Cut Away GMC 500 - 233" Wheelbase

- Alternators, Dual 105 AMP
- Appearance Package - Exterior Deluxe
- Axle Ratio - 5.13 (Rear)
- Batteries, Dual Heavy Duty (1250 CCA)
- Brakes, Front 4-Wheel Disc, 4 Channel ABS, 4-Piston
- Brakes, Rear, 4-Wheel disc, 4 Channel ABS, 2-Piston
- Bumper, Chrome Front
- Cooling System, Heavy Duty Engine Oil & Automatic Transmission
- Cruise Control/Tilt Wheel
- Door Locks, 2 Front, Power
- Duramax 6600, 300HP/520 Lbs.
- Engine Block Heater
- Fast Idle
- Fuel Tank, 60 Gallon
- Headlamps, Halogen
- Horn Dual, Electric
- Insulation, Deluxe Package
- License Plate, Front Bracket
- Mirror, Outside Right & Left Remote
- Power Steering
- Rear Stabilizer Bar
- Rubber Mat, Front Floor, Black Insulated
- Running Boards
- Seating, Heavy Duty Captains Driver & Front Passenger
- Tilt Steering Wheel
- Transmission, Allison 2200 Series
- Tires, Heavy Duty Radials 225/70R19.5
- Wheels, Rear dual
- Windows, 2 Front, Power

Standard Conversion Features

- Air Ride Suspension
- Bumper, Rear Steel Painted Argent
- Console, Removable Ashtray Cup & (2) Cupholders
- Cage, Steel
- Entrance, 4 Step
- Exhaust System, Side Exit Forward of Right Rear Wheels
- Fiberglass Skin (Front & Rear Caps, Roof & Sides)
- Floor Covering, Molded Vinyl
- Floor, 3/4" Plywood, Exterior Grade (Edge Sealed & Undercoated)
- Fuel Cap, Tethered
- Lights, 11, Dome Lights
- Lights, Stepwell (2) Overhead Entry (2)
- Modesty Entry Panel
- Mudflaps, Rear
- Rain Gutter, Full Length
- Rear Stabilizer Bar
- Steps, Under Cab Doors
- Undercoating, Soundproofing Frame & Structure
- Windows, Glass Large Touring w/T Slider, GL 20 Tint w/Black-Out Trim

Optional Conversion Features

- 93,000 BTU Dual Compressor A/C System, with 40,000 BTU Heat Coil
- 35k, 40k or 60k BTU Under Seat Heaters
- 40,000 BTU Dual Compressor A/C with Heat Coil
- 15" Flip down Monitor, Midship Mount
- 40" Electric Bi-Fold Door
- 42" Flat Screen in Rear Partition
- AM/FM Cassette, CD or Combination
- Back Up Alarm
- Back Up Monitor
- Ceiling Mount Handrails
- Ceiling Treatments
- Cargo Net
- DVD Player
- Exterior Key Entry
- Fiberglass Running Boards
- Flush Mount "Plug Door", Side Entry
- Full Rubber Floor
- Lighted Destination Sign
- Overhead Luggage
- PA System
- Painted Skirts
- Rear Cargo Door with Glass
- Rear Side Wheelchair Lift & Accessories
- Remote Heated Mirrors
- Removable Rear Luggage Partition
- Safety Equipment
- Seating, Freedman
- Seats, 19" Wide
- Stainless Wheel Covers w/Valve Stem Extensions
- Television LCD flat Screens - 15", 22" 8" LCD Monitor (available only w/overhead luggage)
- Video Cassette Player

Optional Chassis

- Engine, Duramax 6.600 Turbo Gas

Complete Optional List, contact your local bus dealer or Federal Coach.

Specifications and option availability subject to change without notice.

For more information contact this Federal Coach Dealer.

